

FLYWHEEL, IGNITION COIL AND SWITCH BOX

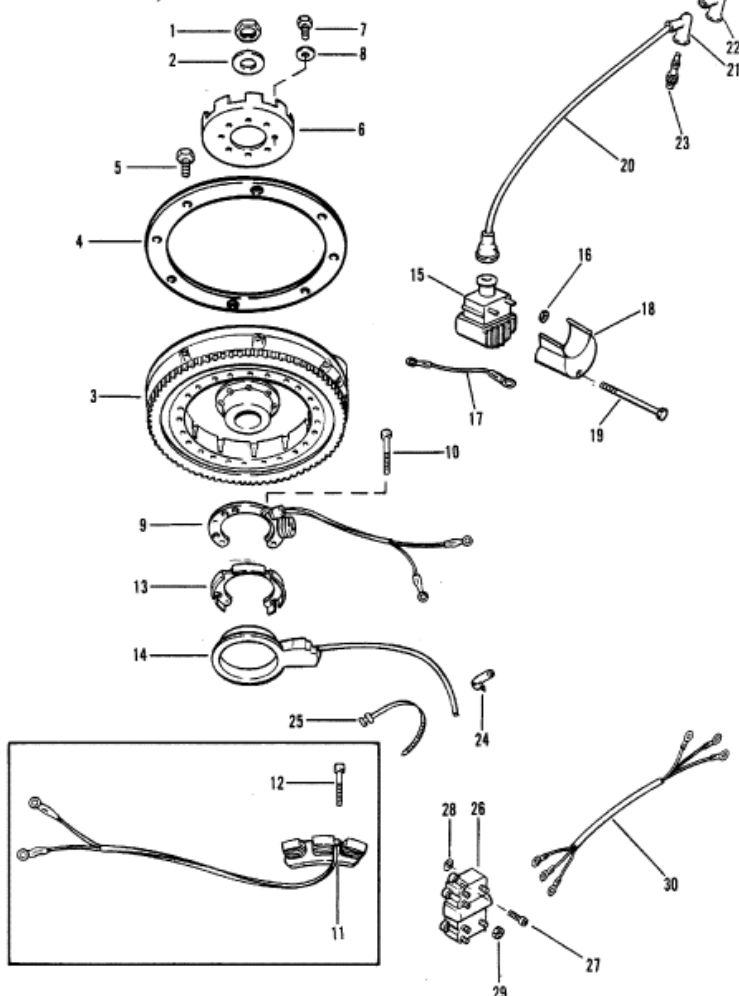

FLYWHEEL, IGNITION COIL AND SWITCH BOX

Parts List						
Ref	Class	Part	Description	Qty	Comment	Footnote
1	11	22339	NUT, FLYWHEEL	1		
2	12	68229	WASHER, FLYWHEEL NUT	1		
3	242	7912A14	FLYWHEEL ASSEMBLY (MANUAL)	1		
3	242	7912A12	FLYWHEEL ASSEMBLY (ELECTR)	1		
4		41409A 1	INERTIA RING ASSEMBLY	1		
5	10	32417	SCREW, FLYWHEEL (5/8")	8		
6	50	65213	RATCHET, FLYWHEEL MANUA	1		
7	10	68997	SCTREW, RATCHET TO FLYWI	8		
8	13	20202	LOCKWASHER, RATCHET SCR	2		
9		86617A11	STATOR (BOLT/NUT CONNECTC	1		
9		86617A13	STATOR (BULLET CONNECTOR	1		
10	10	77363	SCREW, STRATOR TO UPPER E	2		
10	10	76566	SCREW, STATOR TO UPPER EN	2		
11		86704A 2	STATOR ASSEMBLY, CHARGING	1		
12	10	93787	SCREW, STATOR TO UPPER EN	3	ELECTRIC	
13		95707	STRATOR SUPPORT	1		
14		92431A 1	TRIGGER PLATE (BOLT/NUT CO	1		
14		92431A 6	TRIGGER PLATE (BULLET CONN	1		
15	339	7370A13	IGNITION COIL ASSEMBLY	2		
16	11	45076	NUT, COIL TERMINAL	4		
17	84	60466A 8	GROUND WIRE, COIL COVER SC	2		
18		76254	COVER, IGNITION COIL	2		
19	10	69002	SCREW, COVER TO COIL BRACK	2		
19	10	93460	SCREW, COVER TO COIL BRACK	4		
20	84	99215A25	LEAD ASSEMBLY, SPARK PLUG	2		
21	85	63709A 1	PROTECTOR ASSEMBLY	2	FOR CANADA AND BELGIUM US	
22		99213	SHELL, SPARK PLUG BOOT	4		
23	33	97180	SPARK PLUG (NGH#BUHW)	2		
24	54	54457	"J" CLIP, LEAD WIRES	1		
25		61990	STA-STRAP	2		
26	339	7452A 3	SWITCH BOX (BOLT/NUT CONNE	1		
26	339	7452A 8	SWITCH BOX (BULLET CONNEC	1		
27	10	73484	SCREW, SWITCH BOX TO BRAC	3		
28	13	69432	LOCKWASHER, GROUND	1		
29	11	45076	NUT, SWITCH BOX TERMINAL	6		
30	84	94295A 1	HARNES ASSEMBLY	1	PRIMARY (BOLT/NUT CONNEC	